

# DELOITTE OFFICE, LONDON

**Architects:** Sheppard Robson  
**Main Contractor:** BW Workspace  
**Joinery Contractor:** James Johnson  
**Products:** Laudescher LINEA Bespoke  
**Finish:** Pine with a bespoke finish  
**Completed:** Summer 2018

## Project Overview

For Deloitte's London office, Sheppard Robson set out to create a main entrance space that felt calm, warm and welcoming despite the scale and footfall of a major corporate environment. Timber was central to the architectural concept, introducing rhythm and texture while softening the reflective surfaces of the entrance hall.

To ensure the space performed acoustically as well as visually, the project team incorporated Laudescher LINEA slatted timber panels supplied by Acoustic Products, tailored specifically for this project's aesthetic and acoustic requirements.



[acoustic-products.co.uk](http://acoustic-products.co.uk)

## Design Challenge

The main entrance features extensive hard finishes that risked amplifying sound, increasing reverberation and reducing comfort for occupants and visitors. Controlling reflections within a tall, open volume was essential to create a space aligned with Deloitte's client-facing environment - one that feels composed, calm and acoustically balanced.

The challenge: introduce effective sound absorption while maintaining the clean, sculptural timber expression central to Sheppard Robson's design intent.

## Products Used

- Laudescher LINEA Bespoke (aw 0.85, Absorption Class B, NRC 0.9)
- Finish: Pine with bespoke stain and slat configuration

FOR TECHNICAL SUPPORT, SAMPLES  
OR PRODUCT SPECIFICATIONS,  
CONTACT:

 01227 281140

 [enquiries@acoustic-products.co.uk](mailto:enquiries@acoustic-products.co.uk)

## Concept Drawing: Sheppard Robson

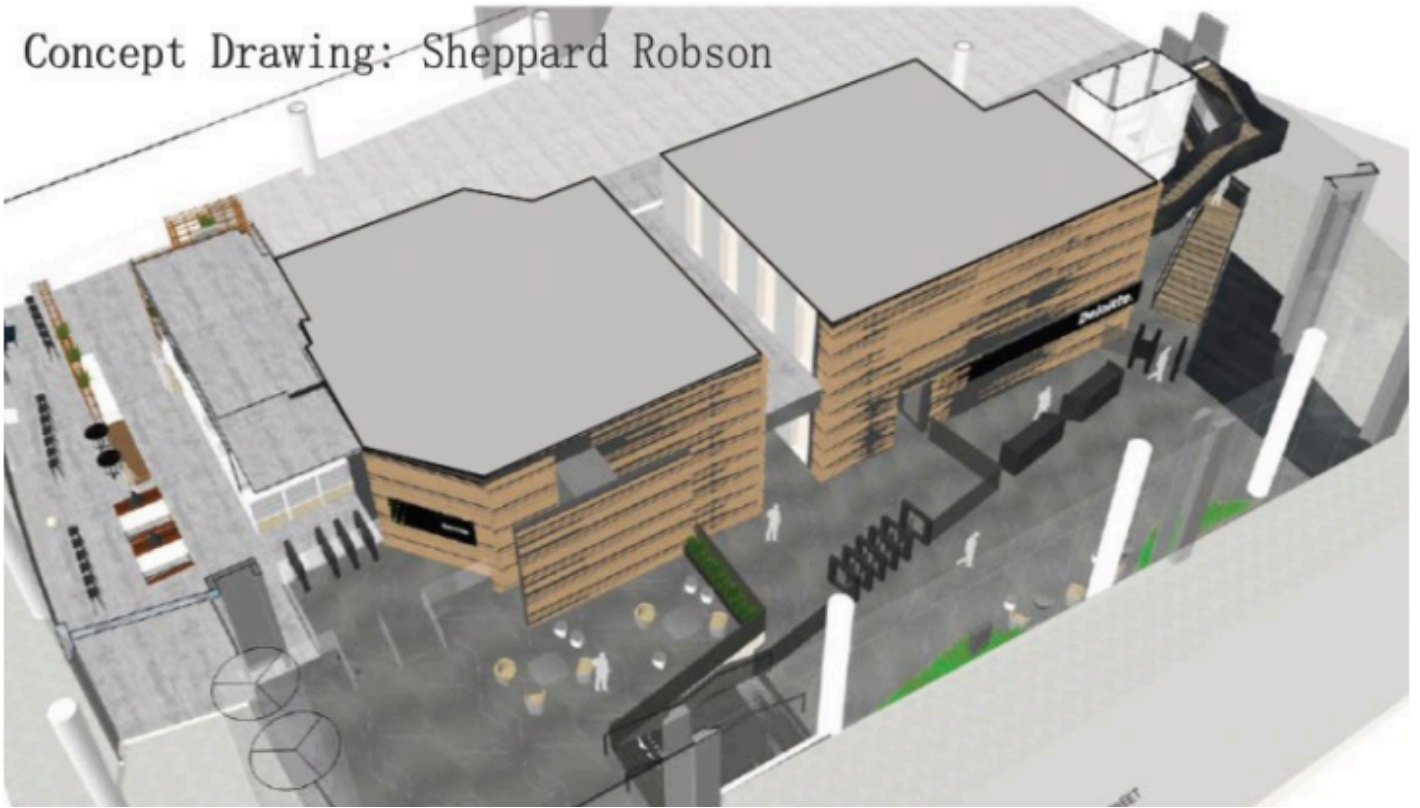

### Acoustic Solution

To meet these requirements, the team specified a bespoke Laudescher LINEA system - a slatted acoustic panel designed to blend architectural texture with proven acoustic performance.

- The system delivers  $\alpha_w$  0.85, Absorption Class B, NRC 0.9, managing reflections and helping reduce overall sound pressure levels.
- The open-joint timber slat geometry ensures broadband absorption while preserving the natural character of the wall composition.
- Panels were integrated across the vertical surfaces of the entrance hall to support speech intelligibility, reduce reverberation and create a more comfortable acoustic environment.

Installed by James Johnson for BW Workspace, the system appears entirely integrated with the interior architecture, performing acoustically without drawing focus away from the surrounding design.

### Material & Finish

The panels were fabricated in pine and completed with a bespoke finish developed to complement the broader material palette of the entrance area.

Careful attention was paid to the tone, grain expression and spacing between slats ensuring the acoustic intervention became a consistent, intentional part of the spatial identity rather than a visible technical layer.

The result is a tactile, visually striking wall treatment that supports the calm, refined atmosphere expected in a flagship corporate environment.



**Lauder LINEA**  
**MUR 2-4.4 12.AL - 1590x1400 A**

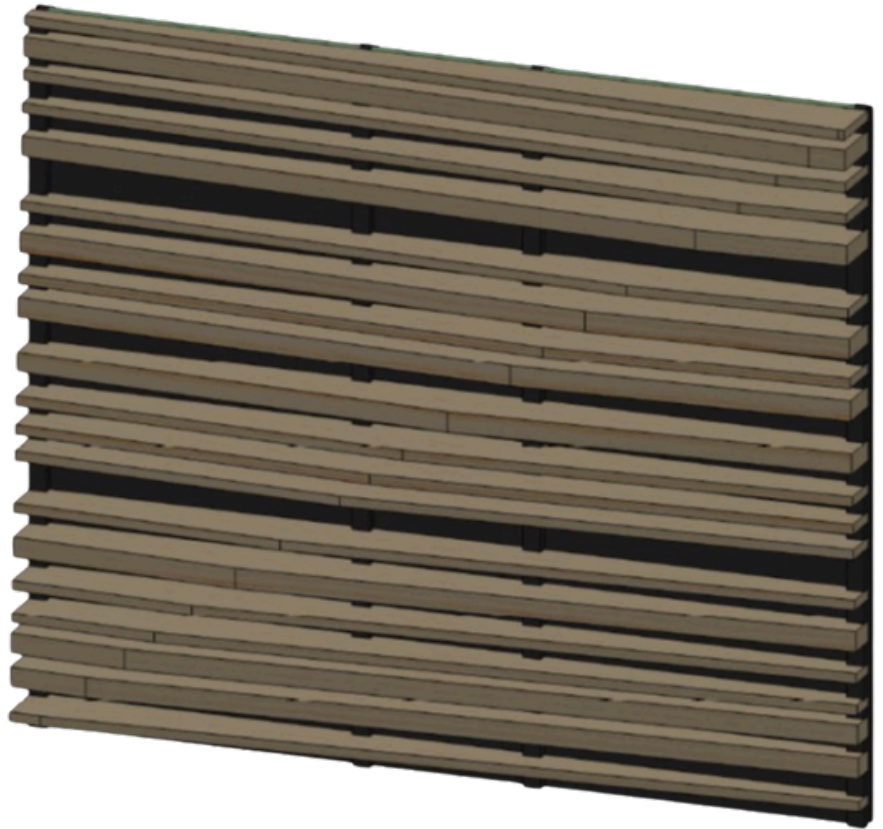

Product references		2.4.3	2.4.5	2.4.6
Slat section	Facing side	20 mm	20 mm	20 mm
	Thickness	42 mm	42 mm	42 mm
Spacing between slats		34.54 mm	55 mm	65.71 mm
Slat distance		54.54 mm	75 mm	85.71 mm
Total thickness		69 mm	69 mm	69 mm
Average void area		63%	73%	77%
Sound absorption data $\alpha_w$ * / absorption class		0.85 / B	0.85 / B	0.85 / B
Reaction to fire		B-s1,d0 / B-s2,d0 / D-s1,d0**		
Installation system		Direct mechanical fixing		

\*Test report, panel with insertion of mineral or stone wool tiles with black fleece facing

\*\* In accordance with the provisions of article AM4 (French regulation) "Vertical walls of unprotected open spaces and buildings" §2, taken from "Fire safety regulations for buildings open to the public"

Edging system:



Weight in Kg/m <sup>2</sup>	2.4.3	2.4.5	2.4.6
Pine	12.4	9.5	8.5
Douglas Fir	12.2	9.4	8.45
Oak	15.9	12.05	10.8





## Project Outcome

The completed reception achieves a clear balance between architectural expression and acoustic comfort. Sound is absorbed effectively across the entrance volume, reducing harsh reflections and creating an atmosphere more suited to greeting clients, facilitating informal conversations and supporting circulation.

With improved speech clarity and a more stable acoustic environment, the Laudescher LINEA system contributes to a workspace that feels both professional and welcoming, demonstrating how design-driven acoustics can elevate corporate interiors.



[acoustic-products.co.uk](http://acoustic-products.co.uk)

FOR TECHNICAL SUPPORT, SAMPLES  
OR PRODUCT SPECIFICATIONS,  
CONTACT:

 01227 281140

 [enquiries@acoustic-products.co.uk](mailto:enquiries@acoustic-products.co.uk)